



**"WE MAKE THE KITCHEN BETTER!"**

**ATOSA USA, INC.**

**Toll Free: 855-855-0399 Email: info@atosausa.com**

www.atosa.com | www.atosausa.com

California, Colorado, Florida, Georgia, Illinois,  
New Jersey, Ohio, Texas, Washington

# Walk-in Freezers

## MODELS:

AWF0606-TF-EL/ER / AWF0608-TF-EL/ER  
AWF0808-TF-EL/ER / AWF0810-TF-EL/ER  
AWF1010-TF-EL/ER / AWF1012-TF-EL/ER

## Standard Features

- White exterior & interior
- 20% more efficient than any walk-in series on the market
- Available in nominal sizes from 6' x 6' up to 10' x 12', all 7'7" high with floor standard (indoor models only)
- Foamed-in-place 4" panels with cam locks
- Top-mount drop in refrigeration system, with low noise level and R404A refrigerant (overall height is 10' with condenser installed, recommend ceiling height 11')
- 3 spring loaded heavy duty Kason door hinges standard
- 36" door with diamond tread kick plates and heated frames standard
- Heavy duty Kason door closer
- Heavy duty Kason door handle with lock and inside safety release
- Exterior ramp (34 1/2" x 27 1/2") standard
- Digital LED light standard
- Reinforced floor standard
- 48" ceiling mount LED standard
- Freezers maintain -8 °F – 0 °F
- 4" thick wall and ceiling panels with R-values of R-29 for coolers



For the best results of food preservation we recommend setting your freezer between -8°F to 0°F

1. Don't forget to leave the unit some room to breathe!
2. Please clean the condenser frequently to give the unit more fresh air.



10 YEAR PANEL WARRANTY  
5 YEAR REFRIGERATION WARRANTY  
1 YEAR HARDWARE WARRANTY



REV. 07/25



**"WE MAKE THE KITCHEN BETTER!"**

**ATOSA USA, INC.**

**Toll Free: 855-855-0399 Email: info@atosausa.com**

www.atosa.com | www.atosausa.com

California, Colorado, Florida, Georgia, Illinois,

New Jersey, Ohio, Texas, Washington

## SPECIFICATIONS

| Models           | Rated Current (A) | Voltage (V/Hz/Ph) | Breaker | HP  | Refrigerant | Exterior Dimensions (inch) | Condensing Unit Weight (lb) | Evaporator Weight (lb) | Panel Weight (lb) |
|------------------|-------------------|-------------------|---------|-----|-------------|----------------------------|-----------------------------|------------------------|-------------------|
| AWF0606-TF-EL/ER | 12                | 208~240/60/1      | 30      | 1.5 | R404A       | 72 x 72 x 117              | 216                         | 218                    | 948               |
| AWF0608-TF-EL/ER | 12                | 208~240/60/1      | 30      | 1.5 | R404A       | 72 x 96 x 117              | 216                         | 218                    | 1120              |
| AWF0808-TF-EL/ER | 30                | 208~240/60/1      | 30      | 3   | R404A       | 96 x 96 x 117              | 243                         | 218                    | 1318              |
| AWF0810-TF-EL/ER | 30                | 208~240/60/1      | 30      | 3   | R404A       | 96 x 120 x 117             | 243                         | 218                    | 1517              |
| AWF1010-TF-EL/ER | 30                | 208~240/60/1      | 30      | 3   | R404A       | 120 x 120 x 117            | 243                         | 218                    | 1743              |
| AWF1012-TF-EL/ER | 30                | 208~240/60/1      | 40      | 3   | R404A       | 120 x 144 x 117            | 243                         | 218                    | 1967              |

## PLAN VIEW

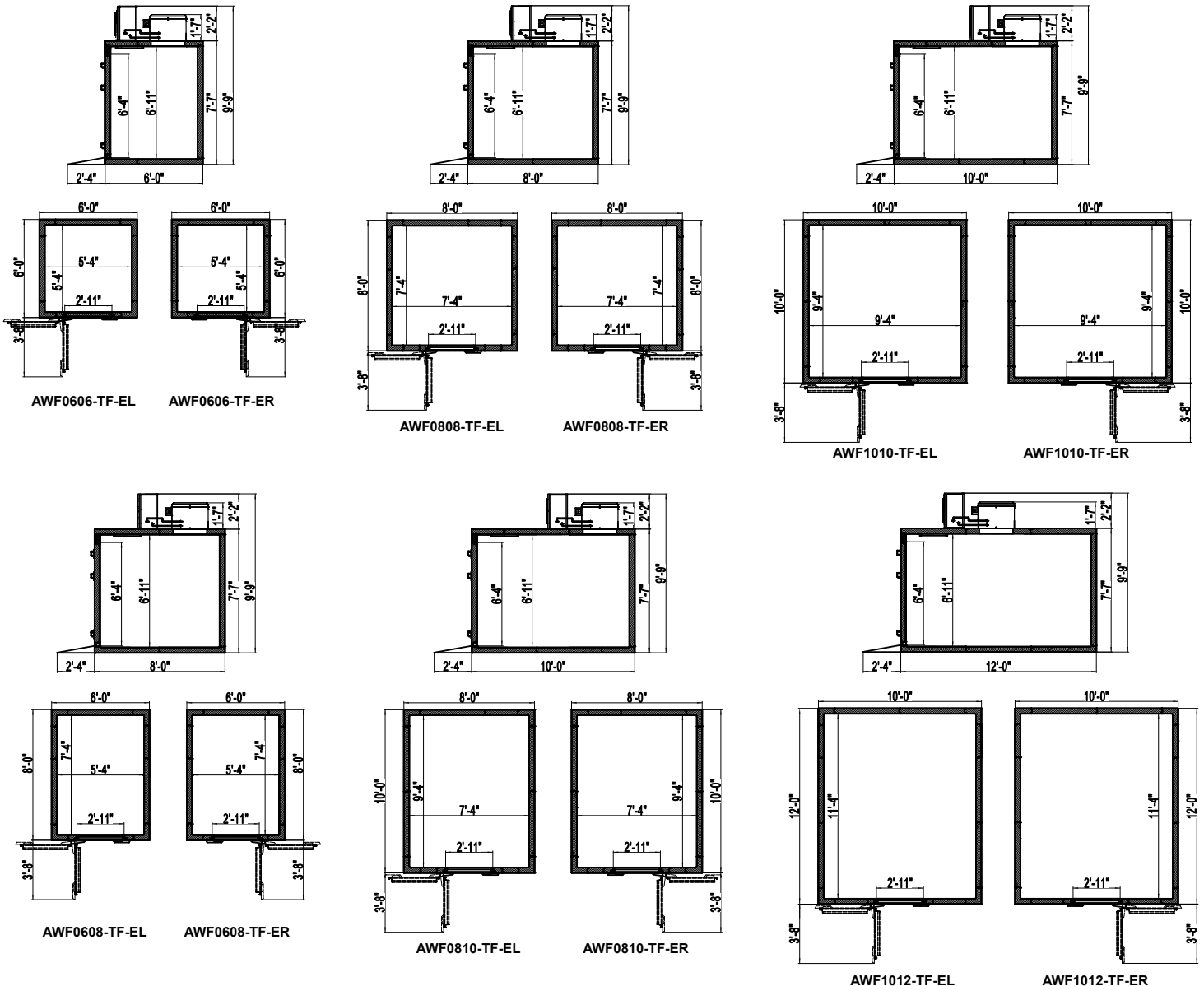



**"WE MAKE THE KITCHEN BETTER!"**

**ATOSA USA, INC.**

**Toll Free: 855-855-0399 Email: info@atosausa.com**

www.atosa.com | www.atosausa.com

California, Colorado, Florida, Georgia, Illinois,  
New Jersey, Ohio, Texas, Washington

## SHELVING UNITS CONFIGURATION

**AWF0606-TF-EL/ER**

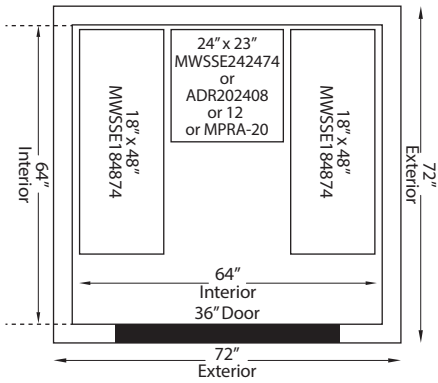

**AWF0810-TF-EL/ER**

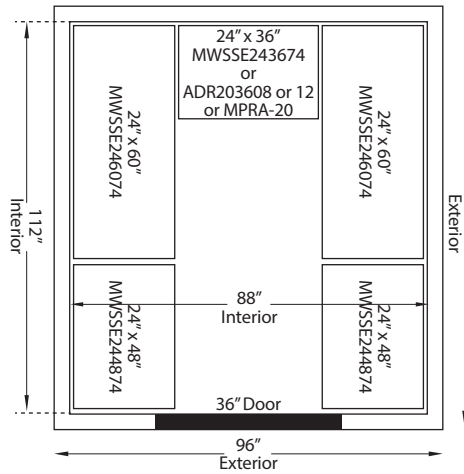

**AWF1010-TF-EL/ER**

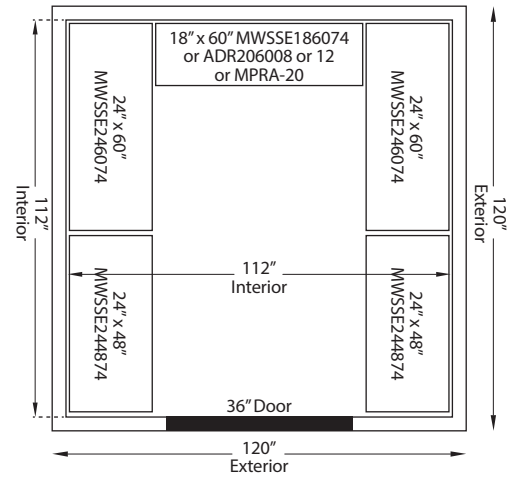

**AWF0608-TF-EL/ER**

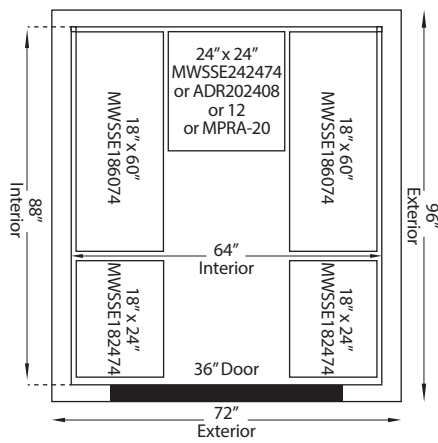

**AWF0808-TF-EL/ER**

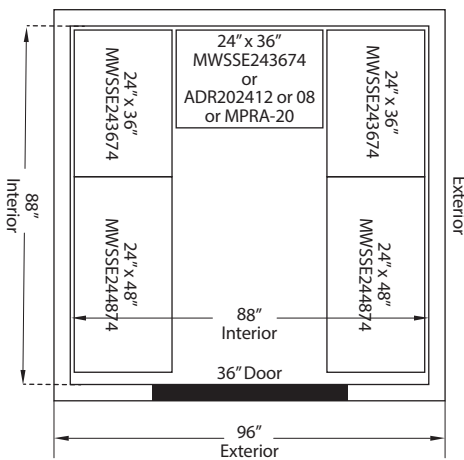

**AWF1012-TF-EL/ER**

